

ATTENZIONE

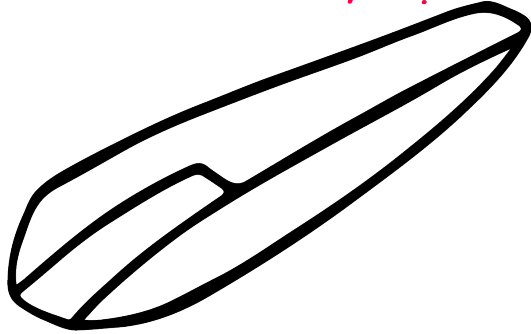

SPECIFICATION

Appearance	
Weight	58,3 grams
Dimensions	108.5x60.5x26.5 mm (length, width, height)
Color	White [Crome]

Temperature Measurement	
Sensor type	Semiconductor
User replaceable sensor	No
Typical sensor life	> 10 years
Sensor self-diagnosis	Yes
Indication on the display	Yes, in turn
Unit of measure	Celsius (°C) degrees
Measuring range	-40 ÷ 100 °C

Supply	
Battery type	Lithium Coin Cell CR2450 3VDC, included
User replaceable battery	Yes
Reverse battery protection	Yes
Typical battery life	> 1 year

Humidity Measurement	
Sensor type	Capacitive
User replaceable sensor	No
Typical sensor life	> 10 years
Sensor self-diagnosis	Yes
Indication on the display	Yes, in turn
Unit of measure	Relative humidity percentage (%RH)
Measuring range	0 ÷ 100 %RH

Viewing	
Display type	Liquid Crystal Display (LCD)
Viewing direction	6 O'CLOCK
Backlight	No

Warning thresholds	
Low concentration of carbon monoxide (CO)	30 ppm, intervention after 15 minutes

Notifications	
Audible alarm	Yes, 85 db at 1 m
Visual alarm	Yes, multicolor LED
Low battery	Yes
Sensor fault	Yes
Sensor End Of Life	Yes
Low concentration of carbon monoxide (CO)	Yes
High concentration of carbon monoxide (CO)	Yes

Alarm thresholds	
High concentration of carbon monoxide (CO)	50 ppm, intervention after 60 minutes
	100 ppm, intervention after 10 minutes
	300 ppm, intervention within 3 minutes

Carbon Monoxide (CO) Measurement	
Sensor type	Electrochemical
User replaceable sensor	No
Typical sensor life	10 years
Sensor self-diagnosis	Yes
Indication on the display	Yes, in turn or fixed in case of CO presence
Unit of measure	Parts per million (ppm)
Measuring range	0 ÷ 999 ppm

Operational characteristics	
Test function of the whole apparatus	Yes, by holding down the TEST button
Warning silencing function	No
Alarm silencing function	No
Fault silencing function	No
Temperature range	5 ÷ 45 °C
Humidity range	10 ÷ 90 %RH

Carbon Monoxide (CO) Measurement	Mode	Green LED (supply)	Yellow LED (fault)	Red LED (alarm)	Acoustic signal	Display
Active detection	1 flash/min	-	-	-	-	Numeric value
Warning	1 flash/min	-	-	-	5 close beeps/min	Numeric value
Alarm	1 flash/min	-	-	Alternate, 25 flashes/min	Alternate, 25 beeps/min	Numeric value
Low battery	1 flash/min	-	1 flash/min	-	1 beep/min	bAt FAU EOL
Sensor fault	1 flash/min	-	2 close flashes/min	-	2 close beeps/min	
Sensor End Of Life	1 flash/min	-	3 close flashes/min	-	3 close beeps/min	

! WARNINGS!



- Read the instruction booklet carefully before using the product as it provides important information regarding safety, use and maintenance. Keep the instruction booklet carefully for future reference.
- This detector does not require installation or the intervention of qualified personnel. An essential element for the optimal functioning of the detector is its correct positioning: by carefully following the instructions given in this booklet, you will obtain high accuracy combined with the absence of false alarms.
- The appliance is only suitable for applications in a domestic or similar environment. For applications in particular environments, consult the specific environmental regulations. Any use other than that which the signaling device was designed is to be considered improper; therefore the manufacturer declines all responsibility for any damage caused to people, animals or things.
- Make sure the integrity of the product after removing it from the packaging box.
- To serve you for a long time and to the satisfaction of your signaler, use it bearing in mind the following precautions:
 - o Do not allow it to become wet. The product is not waterproof either when immersed in water or exposed to high levels of humidity.
 - o Don't drop it. Strong blows or falls during transport or installation can damage the appliance.
 - o Avoid sudden changes in temperature. Sudden changes in temperature can cause condensation to form and the detector may not function properly.
- Never clean the appliance with chemicals. If necessary, wash with a damp cloth. Absolutely avoid approaching cloths soaked in diluents, alcohol or chemical detergents.
- The user periodically (every six months), must carry out a test (TEST) using the appropriate button to ensure the proper functioning of the indicator over time. At least once a year it is recommended to have a more accurate check carried out by a specialized technician.

"END OF LIFE" DISPOSAL OF ELECTRICAL AND ELECTRONIC APPLIANCES



This symbol on the product or its packaging indicates that this product shall not be treated as household waste. Instead, it shall be handed over to the applicable collection point for the recycling of electrical and electronic equipment, such as for example: - sales points, in case you buy a new and similar product - local collection points (waste collection centre, local recycling center, etc...). By ensuring this product is disposed of correctly, you will help prevent potential negative consequence for the environment and human health, which could otherwise be caused by inappropriate waste handing of this product. The recycling of materials will help to conserve natural resources. For more detailed information about recycling of this product, please contact your local city office, your household waste disposal service or the shop where you purchased the product. Attention: in some countries of the European Union, the product is not included in the field of application of the National Law that applies the European Directive 2012/19/EU and therefore these countries have no obligation to carry out a separate collection at the "end of life" of the product.

BEINAT Via Fatebenefratelli 122/C - San Maurizio Canavese (TO)
GAS SOLUTIONS Tel: 0119210484 - www.beinat.com

DESCRIZIONE

- Rilevatore portatile di monossido di carbonio
- Misura temperatura ambiente
- Misura umidità relativa
- Display a cristalli liquidi
- LED multicolore di segnalazione visiva
- Potente allarme acustico (85 db a 1 m)
- Autodiagnostica sensore per assicurare sempre il corretto funzionamento
- Lunga durata (vita sensore fino a 10 anni)
- Batteria bottone al Litio sostituibile
- Protezione immediata, non necessita di installazione

INSTALLATION AND LOCATION

In rooms with combustion appliances (E.g. : kitchen)

- Position the carbon monoxide detector respecting a distance of 1 m to 3 m from combustion appliances.

In rooms without combustion appliances (e.g. bedrooms)

- Place the carbon monoxide detector 80-120 cm maximum from the floor.

- If the building unit has several floors, communicating with each other, it is advisable to place additional gas detectors on each level and / or in each bedroom.

Warning: do not install the carbon monoxide detector behind barriers that may hinder the prompt detection of the gas and in the vicinity of: sinks, air vents, heating and air conditioning devices, windows and ventilation devices.



THE INSTALLATION OF THE GAS SIGNALER DOES NOT EXEMPT FROM COMPLIANCE WITH ALL THE LAWS AND REGULATIONS IN FORCE IN THE COUNTRY OF INSTALLATION REGARDING THE CHARACTERISTICS, INSTALLATION AND USE OF GAS APPLIANCES, VENTILATION OF THE ROOMS AND DISCHARGE OF COMBUSTION PRODUCTS.

COMPONENTS AND CONTROLS

A: LED indicator - see the meaning of the indications in the table below.

B: LCD display - during normal operation it displays in sequence the carbon monoxide, temperature and relative humidity indications.

C: battery replacement screws - provides access to the battery compartment.

D: test button - press and hold to check the functionality of the acoustic signal and the LED indicator

Legend of LEDs icons

	Power present.
	Device malfunction or low concentration warning detected.
	High concentration alarm detected.

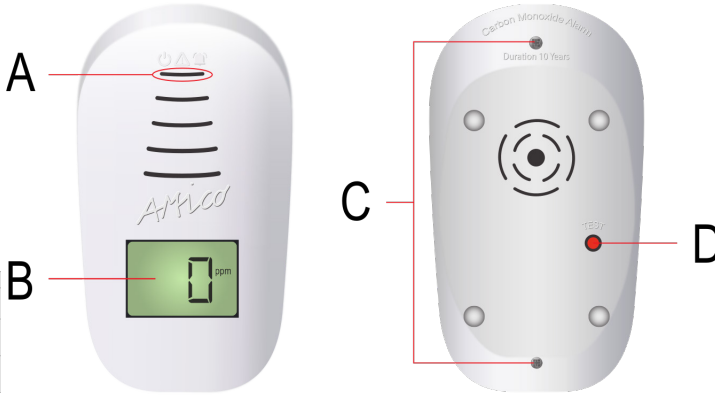

POWERING UP

E: Remove the tab to start amiCO for the first time.

F: a sequence will start which includes: emission of an acoustic signal, emission of a green, yellow and red light signal and display of all the indications. From this moment the protection will be active.

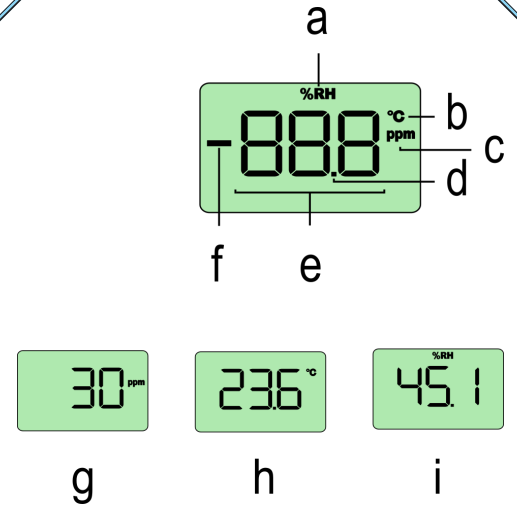
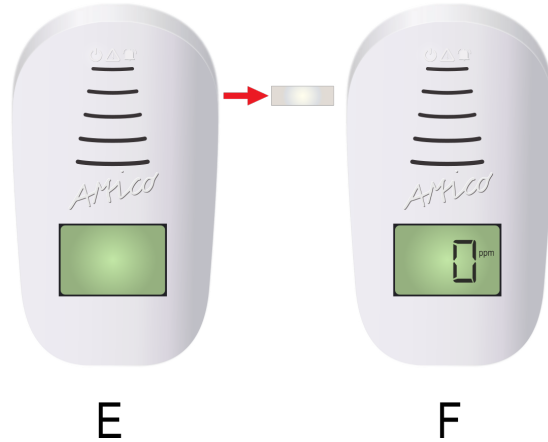

DISPLAY KEYS

- a: percentage of relative humidity.
- b: degrees Celsius.
- c: parts per million.
- d: decimal point.
- e: numeric value.
- f: negative value.
- g: carbon monoxide indication.
- h: temperature indication.
- i: relative humidity indication.

CARBON MONOXIDE EFFECTS ON THE HUMAN BODY

ppm	Sintomi
150	Mild headache in 3 hours.
200	Moderate headache in 2 hours.
450	Severe headache, dizziness in 45 minutes.
800	Severe headache, dizziness, nausea, cramps, convulsions in 30 minutes.
1500	Severe headache, dizziness in 5 minutes; death in 2 hours.
5000	Severe headache, dizziness in 2 minutes; death in 15 minutes.

This equipment is designed to protect individuals from the acute effects of exposure to carbon monoxide. This equipment will not fully protect individuals with specific medical conditions. If in doubt, consult a doctor.

BATTERY REPLACEMENT

G: remove the screws.

H: remove the battery.

I: insert the new battery.

L: insert the screws again. Attention, the screws are not interchangeable: the shorter screw must be inserted at the bottom.

